

CERCA DE ARAME QUE LIMITA O DISTRITO INDUSTRIAL

(460.5, 9199.5)

(460.5, 9198.5)

TRANSFORMAÇÃO DO LOTEAMENTO EM ZONA DE INTERESSE SOCIAL

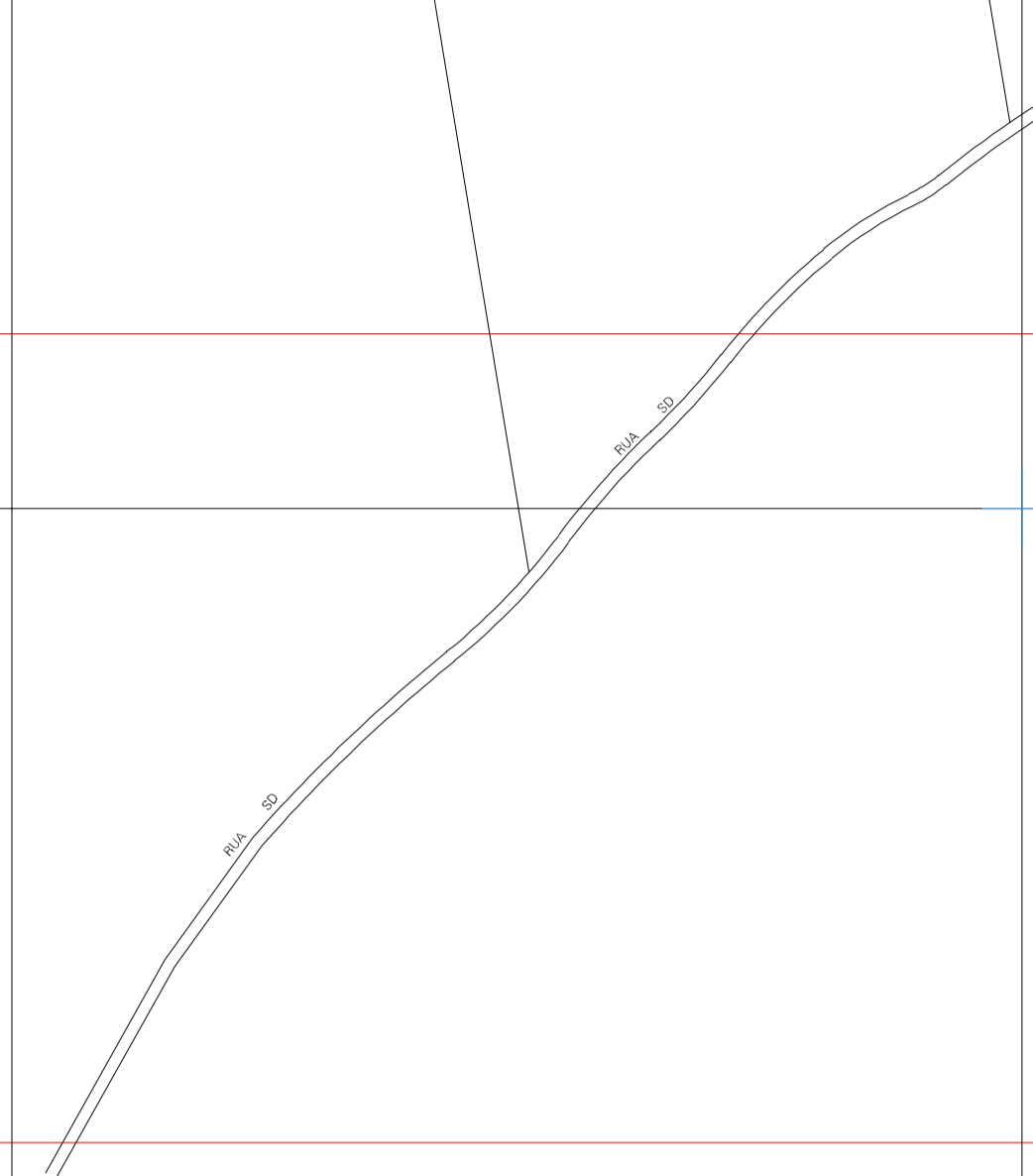

(462.5, 9199.5)

(462.5, 9198.5)

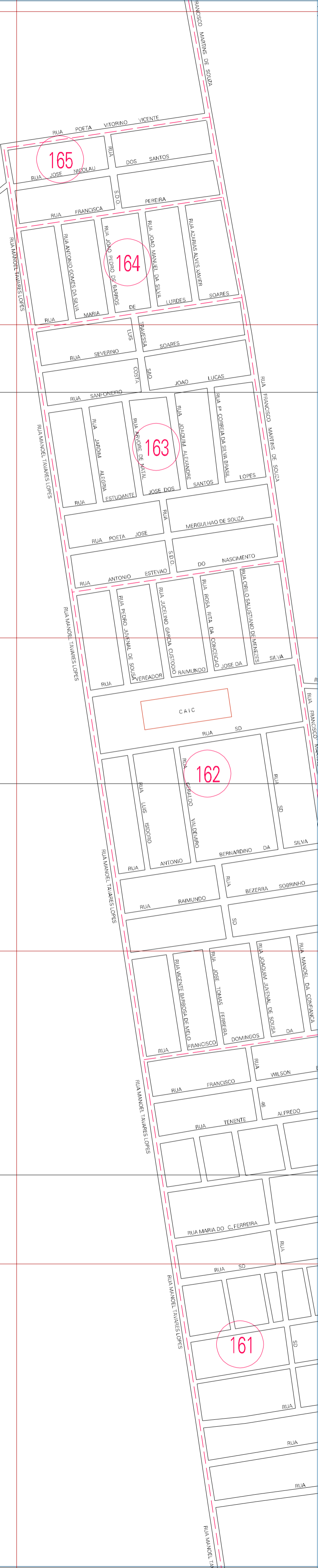

165

164

163

162

161

166

029

BAIRRO JARDIM GONZAGA

214